



S-SERIES NEXT GENERATION CODING



The new Needham S-SERIES range of printers now offers unbelievable print quality in a fully featured compact printer.

The **S-6000** can be used as a simple stand-alone, easy to program printer or alternatively integrated into a full production network system. Ideal for quick and easy product and box coding.

The **S-7000** features a larger high-resolution printing height of up to 70mm with production versatility, clean ink management and advanced connectivity technology.

The **S-1000** is a modular inkjet system that allows you to connect up to four S-1000 printers together with an S-1000 controller to suit your application.

Capabilities

Lines of Print

Up to 8 lines of text per print head.

Image Height

S-6000

17mm print height (34mm with the S-6000 Plus Duo).

S-7000

50mm print height (70mm with the S-7000 Quattro).

S-1000

17mm print height

Print Speeds

Up to 100m/min print speed. (30m/min for bar codes and 3mm text).

S-SERIES - High Resolution Marking

Product, Carton, Box & Web Printing

Improved Product Image

High resolution printing combined with the ability to import your own font styles and graphics will enhance your product image. Printing directly onto your cartons, sacks, trays and other porous surfaces will save time and money, eliminating costly pre-printing or expensive labels.

Low Cost Maintenance

The S-SERIES has been designed with minimal components to give maximum reliability. No pumps, no valves, no compressed air and the use of just a single PCB means low maintenance.

Reduced Print Costs

Printing with micro ink droplets and a sealed ink cartridge gives low cost per print with no ink wastage. Additional cost savings can be obtained using the 'economy-print' type font.

Operator Confidence

The S-SERIES has the option to select from three different levels of message programming and editing, from very easy and basic to multi-functional programming.



S-6000R Plus / Product Coding

S-6000R Plus Remote - Manual

Ideal for product coding and best before dates, with a manual print head.

- Use only oil ink for absorbent surfaces.
- Use only solvent ink for non absorbent surfaces.
- Solvent ink use will require head to be sprayed after production breaks.
- Manual print head can be positioned low down on product.
- Manual print head can print on top of product or on angled side.



Specification
Manual print head
17mm print height
180dpi print resolution
500mm conduit
Standard mounting bracket
1 black 110ml cartridge, cleaner cartridge, spray cleaner
2 x interface ports RS232 + RS485
Optional 7-way round sockets (F) -3 max
Optional ethernet connection
Optional additional photocell

S-6000R Plus Remote - Motorised

Ideal for product coding and best before dates, with a motorised print head.

- For use with oil or solvent ink.
- Motorised Print head will continue printing after production breaks without operator intervention.
- Motorised Print head is ideal in dusty environments.
- Motorised print head can be positioned low down on product.
- Motorised print head can print on top of product or on angled side.
- Motorised shutter is ideal for fully automated continuous printing with minimal operator intervention.



Specification
Motorised print head
17mm print height
180dpi print resolution
500mm conduit
Second shutter photocell
Standard mounting bracket
1 black 110ml cartridge, cleaner cartridge, spray cleaner
2 x interface ports RS232 + RS485
Optional 7-way round sockets (F) -3 max
Optional Ethernet connection

S-6000 Plus / Box Coding

S-6000 Plus Standard

Perfect for cartons, printing up to 17mm text and bar codes.

- Simple to install with print head fitted internally, which includes an ink cartridge.
- Uses only oil based ink for absorbent surfaces.
- Option of importing custom fonts and graphics.
- Optional remote print head for printing in confined spaces.

S-6000 Plus Duo

Perfect for cartons, printing up to 34mm text and bar codes.

- Uses only oil based ink for absorbent surfaces.
- Will print up to 34mm print height (2 x 17mm).
- Encoder required to stitch print heads if character height is either over 17mm or across both heads. (Encoder and output port included in price).
- Flatbed conveyor needed for best quality printing.
- Option of importing custom fonts and graphics.



Specification
17mm Print Height
180dpi Print Resolution
Standard Mounting Brackets
Integrated Photocell
1 black 110ml cartridge, cleaner cartridge, spray cleaner
2 x interface ports RS232 + RS485
Optional 7-way round sockets (F) -3 max
Optional Ethernet connection

Specification
34mm Print Height. (2 x XJ128)
180dpi Print Resolution
Standard Mounting Brackets
Integrated Photocell
1 black 110ml cartridge, cleaner cartridge, spray cleaner
2 x interface ports RS232 + RS485
Optional 7-way round sockets (F) -3 max
Optional Ethernet connection

S-7000 / Flexible Coding

S-7000 Trio

Ideal for high resolution printing directly onto cartons, trays and sacks, with a printing height of up to 50mm; either as a stand-alone unit or on a production line.

- For use with oil inks (including colours and special application inks) for porous surfaces.
- Printer can be linked with other S-7000 Trio or Quattro printers for multiple side printing with the same or different messages.
- The easy-flow oil based ink is in a sealed ink cartridge to ensure no waste and easy replacement.



S-7000 Quattro

The Quattro's 70mm print height is the largest of the S-SERIES range, and is ideal for sizeable high resolution printing.

- For use with oil inks (including colours and special application inks) for porous surfaces.
- Full integration capability for networking printers, accessing databases, connecting to industrial scanners, bar code readers and other production equipment.
- Printer can be linked with other S-7000 Trio or Quattro printers.



Specification
50mm to 2mm text and graphics
180dpi Print Resolution
100m/min print speed (30m/min for barcodes and 3mm for text)
Optional higher speed print head
Multi language support (optional foreign keypads)
RS232/485 connectivity
Sealed replaceable ink cartridge (1/2Ltr)
Full integration with network and databases
Optional Ethernet connection

Specification
70mm to 2mm text and graphics
180dpi Print Resolution
100m/min print speed (30m/min for barcodes and 3mm for text)
Optional higher speed print head
Multi language support (optional foreign keypads)
RS232/485 connectivity
Sealed replaceable ink cartridge (1/2Ltr)
Full integration with network and databases
Optional Ethernet connection

S-1000 / Flexible Coding

S-1000 Controller



- Controller has all the operational and editing features of a 6000 Plus.
- Can be sited up to 10 meters from the individual S-1000 print heads.
- Ideal use when controller access needs to be outside machine guards.
- Ideal when print heads are in inaccessible positions.
- Photocell input for product detect and motorised shutter can be connected to either controller or any S-1000 Printer.

Specification

Controls up to 4 x 1000 print heads
2 x interface ports RS232 + RS485
Optional 7-way round sockets (F) - 3 max
Optional Ethernet connection
Mounting bracket



S-1000 Printer – Remote, Manual



- For use with oil or solvent based ink.
- Allows remote manual print head and ink supply to be located separately.
- Full connectivity between print head and controller by single 25 way cable (including photocell and low ink signals).
- 10M max print head to controller.
- Product detect photocell can be connected to either the controller or to one S-1000 (only one photocell required per system).

Specification

17mm manual print head
500mm conduit
110ml cartridge
Connection for S-1000 controller.
Connection for optional photocell
Standard mounting brackets
2m controller cable (more available)



S-1000 Printer – Remote, Motorised



- For use with oil or solvent based ink.
- Allows remote motorised print head and ink supply to be located separately.
- Full connectivity between print head and controller by single 25 way cable (including photocell and low ink signals).
- 10M max print head to controller.
- Product detect photocell can be connected to either the controller or to one S-1000 (only one photocell required per system).

Specification

17mm motorised print head
500mm conduit
110ml cartridge
Connection for S-1000 controller.
Connection for optional photocell
Standard mounting brackets
2m controller cable (more available)
Electronic shutter advance



S-SERIES / Standard Features

Feature	Specification
Lines of text	Up to 8 lines of text per print head
Text height	5 standard text heights 2mm – 17mm
Fonts	Up to 10 font styles
Max print height	17mm total print height per print head
Resolution	128 vertical dots/17mm (180dpi)
Coding output	Graphics, logos and bar codes
Time and date	Date, time and shift
Counter	Incremental and decremental numbering and batch counting
Max print speed	100m/min print speed (30m/min for bar codes and 3mm text)
Message storage	100 message storage - expandable
Connectivity	RS232/485 connectivity
Power requirement	Auto voltage detect, single phase 90 – 260V, 50 – 60Hz, 0.5A
Ink delivery	Various colours and special application inks, solvent and oil based formulations

S-6000 Printer – Dimensions

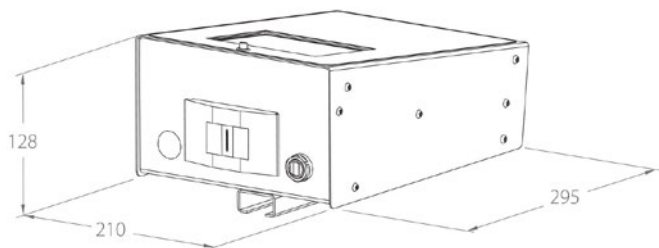

S-1000 Printer – Application

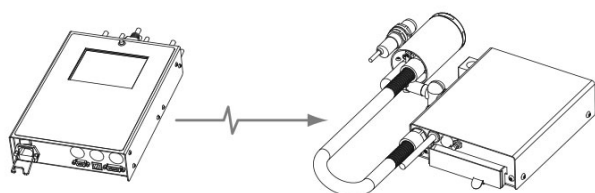

Print in a remote location.

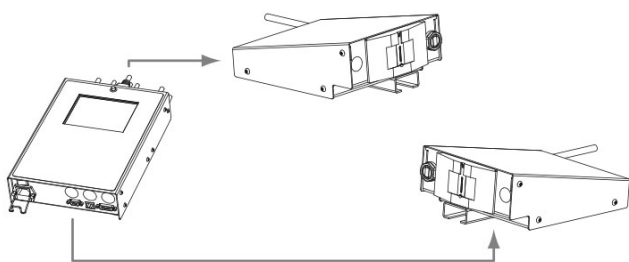

Print on 2 sides of a product.

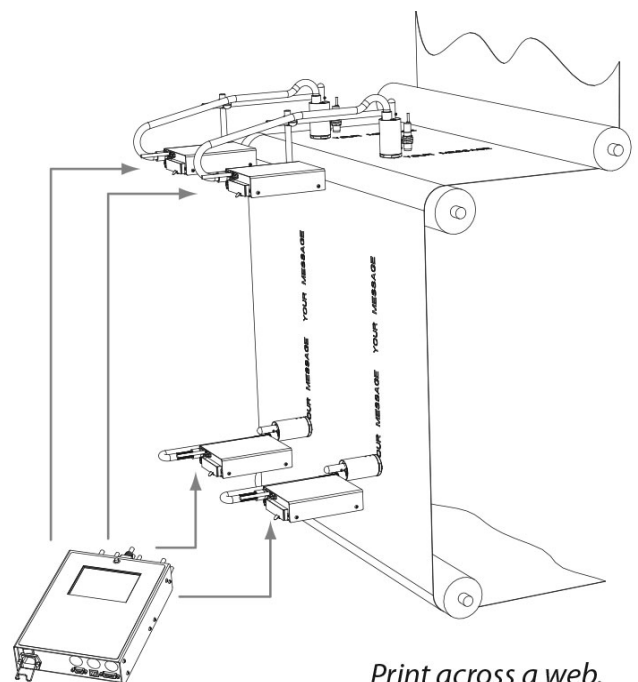



Print across a web.



Needham Coding Ltd
Unit 6 Chambers Way, Thorncliffe
Park, Sheffield, S35 2PH

Phone: +44 (0) 114 2570007
Email: info@needham-coding.com
Web: www.needham-coding.com

 www.linkedin.com/company/needham-coding
 www.facebook.com/company
 [@needhamcoding](https://twitter.com/needhamcoding)

 Needham Coding Ltd 2017